

PANEL REAR MOUNTED CABLE RECEPTACLE

GENERAL INFORMATIONS

Part number	135211
Designation	DKBE 104 A087-80E+
Product line	Core Series Brass
Series size	104
Connector type	Receptacle
Body style design	Cable mounted
Housing material	Brass
Housing color	Grey
Contact termination	Solder
Contact gender	Female
Contact configuration	Mixed low voltage
Locking system	Plug-related
Mounting type	Panel Rear Mounted
Cable diameter (min - max) [mm]	-
Panel cut-out diameter [mm]	18.1
Data protocol compliance	USB 2.0 up to 480Mbit/s



Picture for illustration purpose only.
Contact configuration may vary- refer to pin layout.

DIMENSIONS

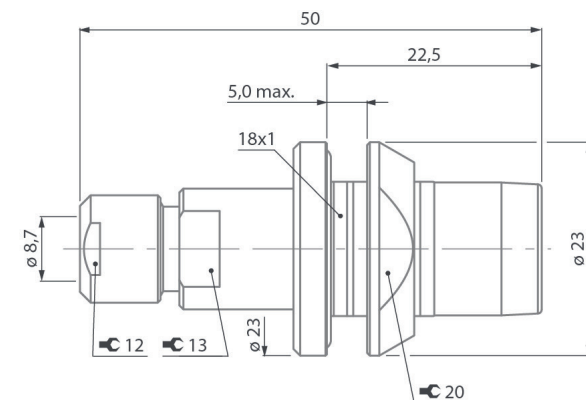

KEYING CODE



PIN LAYOUT



All dimensions and images shown are in millimeters and are for reference only.

ELECTRICAL & CONTACT CONFIGURATION

Number of contacts	Contact type	Insultator material	Contact Ø [mm]	Pin Ø [mm]	Ground pin Ø [mm]	Wire size min [AWG]	Wire size max [AWG]	Test voltage AC r.m.s [kV] in mated position		Test voltage DC [kV] in mated position		Current per contact [A]
								Contact to body	Contact to contact	Contact to body	Contact to contact	
2	Low voltage	PEEK	2.3	-	-	-	11	1.5	1.6	2.2	2.5	28
2	Low voltage	PEEK	0.9	-	-	-	21	2	1.6	2.8	2.5	3

ENVIRONMENTAL & MECHANICAL DATA

Characteristic	Value	Standard
Corrosion resistance	Salt mist, 1000 hours ; 5% salt solution, 35°C	IEC 60068-2-11 Test Ka // MIL-STD-202 Method 101 Condition A // EIA-364-26
Endurance	10'000	IEC 60512-2-1, Test 2a // IEC 60512-2-2, Test 2b
Vibration resistance	10 to 2000 Hz, 1,5 mm or 15 g, 12 sweep cycles per axis, 20 minutes per 10-2000-10 Hz sweep cycle, no discontinuity > 1us	MIL-STD-202 Method 204 Condition B
Shock resistance	On request	On request

For this connector, you need to select from the following clamp sets

E ENVIRONMENTAL CLAMP SET

Environmentally sealed clamp for use with shielded or unshielded cables.

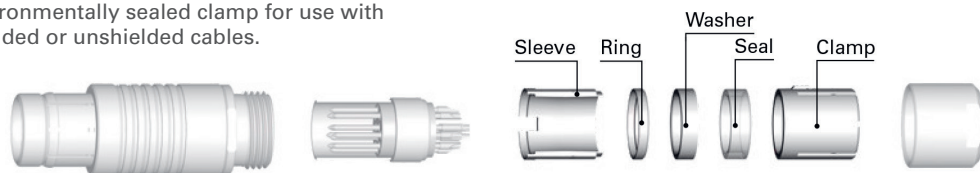

Characteristic	Value	Standard
Sealing performance	IP68 / IP69K	IEC 60529
Operation temperature	From -50 °C to 130 °C	IEC 60512-6-11 i+j // IEC 60068-2-14-Nb